



**LOGISTICS<sup>®</sup>**  
PROPERTY  
CO

# FIRST STATE LOGISTICS PARK

2051 Old Cooches Bridge Road, Newark, Delaware 19702



## BUILDING D - 294,600 SF

- Located in the heart of the I-95 corridor between NYC and Washington, DC
- Immediate access to I-95 (1.5 miles)
- Abundant labor force within the region drawing from Delaware, New Jersey, Pennsylvania, and Maryland
- Access to one-third of the US population within a one-day drive
- Modern industrial buildings
- Access to three ports within a one-hour drive (Wilmington, Philadelphia, and Baltimore)
- Secure, park-like setting with a lake on the property
- Ready for tenant improvements

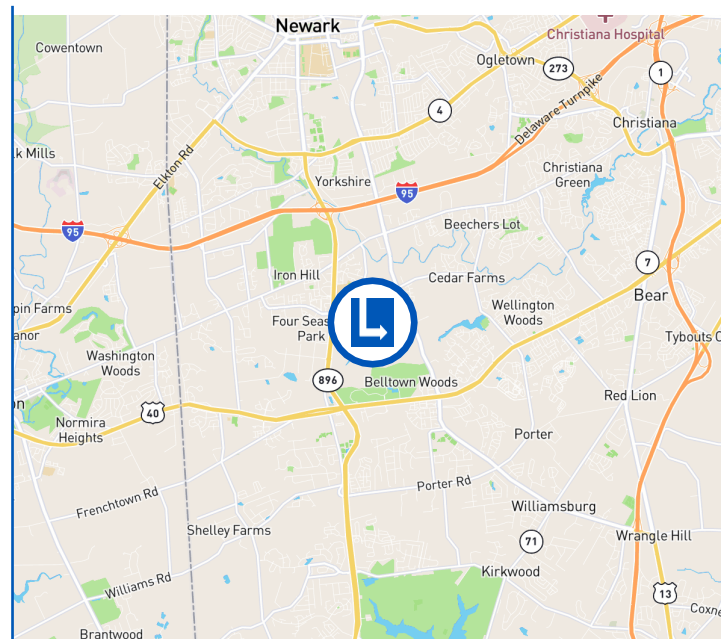



**LOGISTICS<sup>®</sup>**  
PROPERTY  
CO

# FIRST STATE LOGISTICS PARK

2051 Old Cooches Bridge Road, Newark, Delaware 19702



## PROPERTY HIGHLIGHTS

### Building D

- Type: Tilt wall, single load/rear load
- Dimensions: 1,178' (w) x 250' (d)
- Clear Height: 40'
- Column Spacing: 54' x 48'
- Speed Bay: 60'
- Floor: 8" slab
- Sprinkler: ESFR
- Loading: 63 dock doors, 2 drive-in doors
- Parking: 89 trailer spots, 234 auto spots



# CBRE

CBRE, Inc.  
3711 Kennett Pike, Suite 210  
Wilmington, DE 19807

**Dan Rattay**

+1 302 661 6702 • [dan.rattay@cbre.com](mailto:dan.rattay@cbre.com)

**Paul Touhey**

+1 610 251 5126 • [paul.touhey@cbre.com](mailto:paul.touhey@cbre.com)



**LOGISTICS<sup>®</sup>**  
**PROPERTY**  
**CO**

# FIRST STATE LOGISTICS PARK

2051 Old Cooches Bridge Road, Newark, Delaware 19702

[www.firststatelogisticspark.com](http://www.firststatelogisticspark.com)

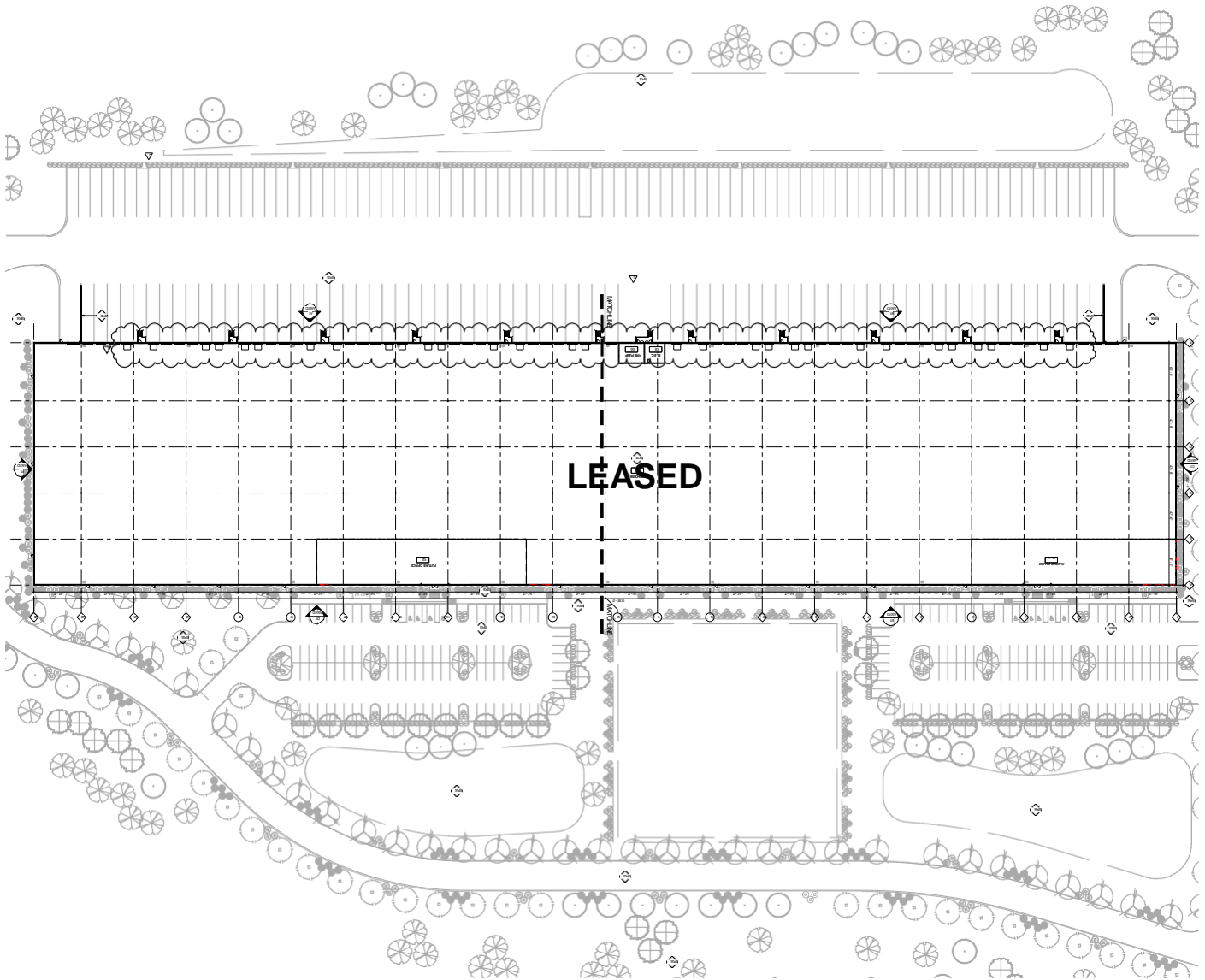



**LOGISTICS<sup>®</sup>**  
PROPERTY  
CO

# FIRST STATE LOGISTICS PARK

2051 Old Cooches Bridge Road, Newark, Delaware 19702

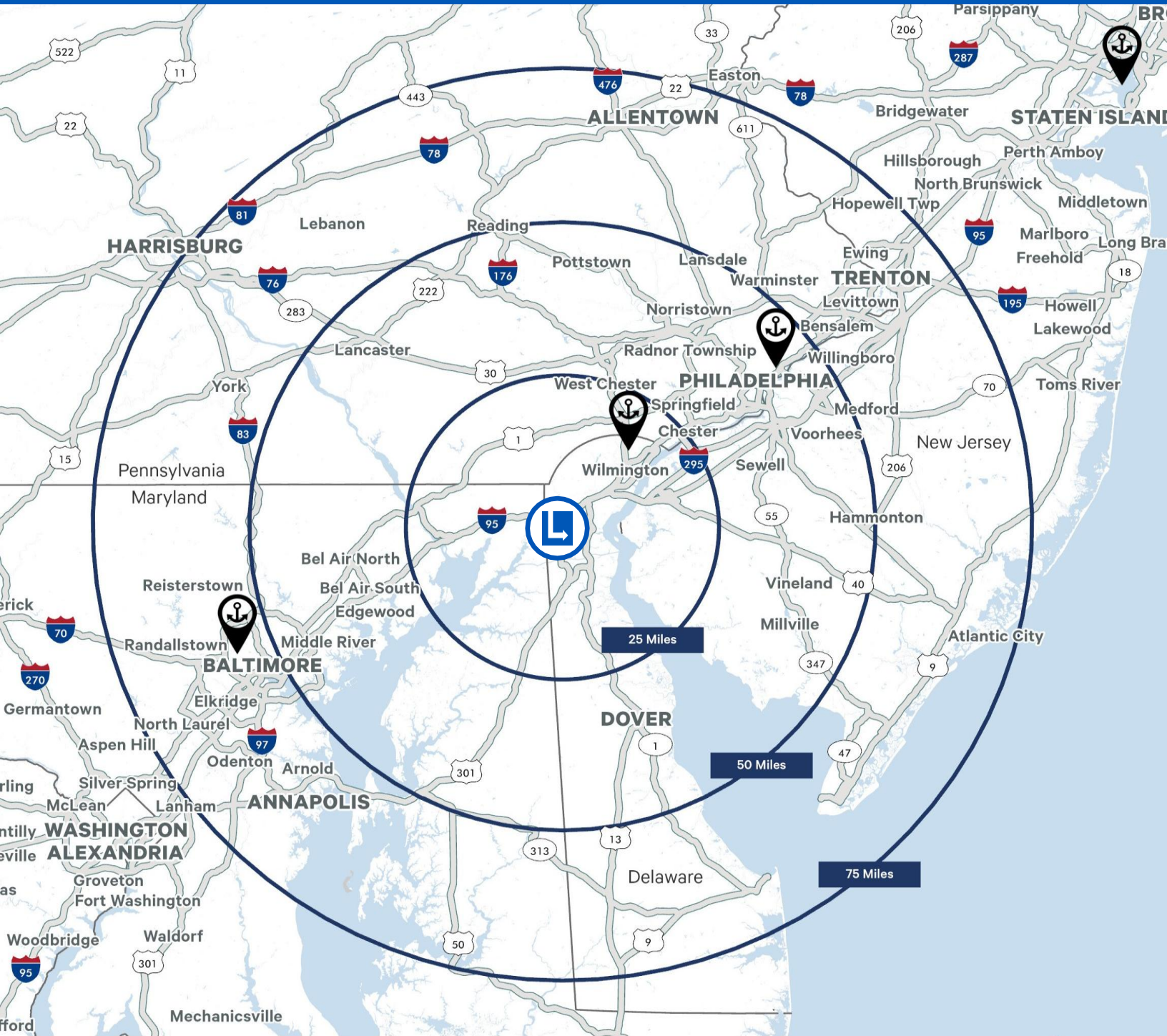



**LOGISTICS<sup>®</sup>**  
PROPERTY  
CO

# FIRST STATE LOGISTICS PARK

2051 Old Cooches Bridge Road, Newark, Delaware 19702

[www.firststatelogisticspark.com](http://www.firststatelogisticspark.com)

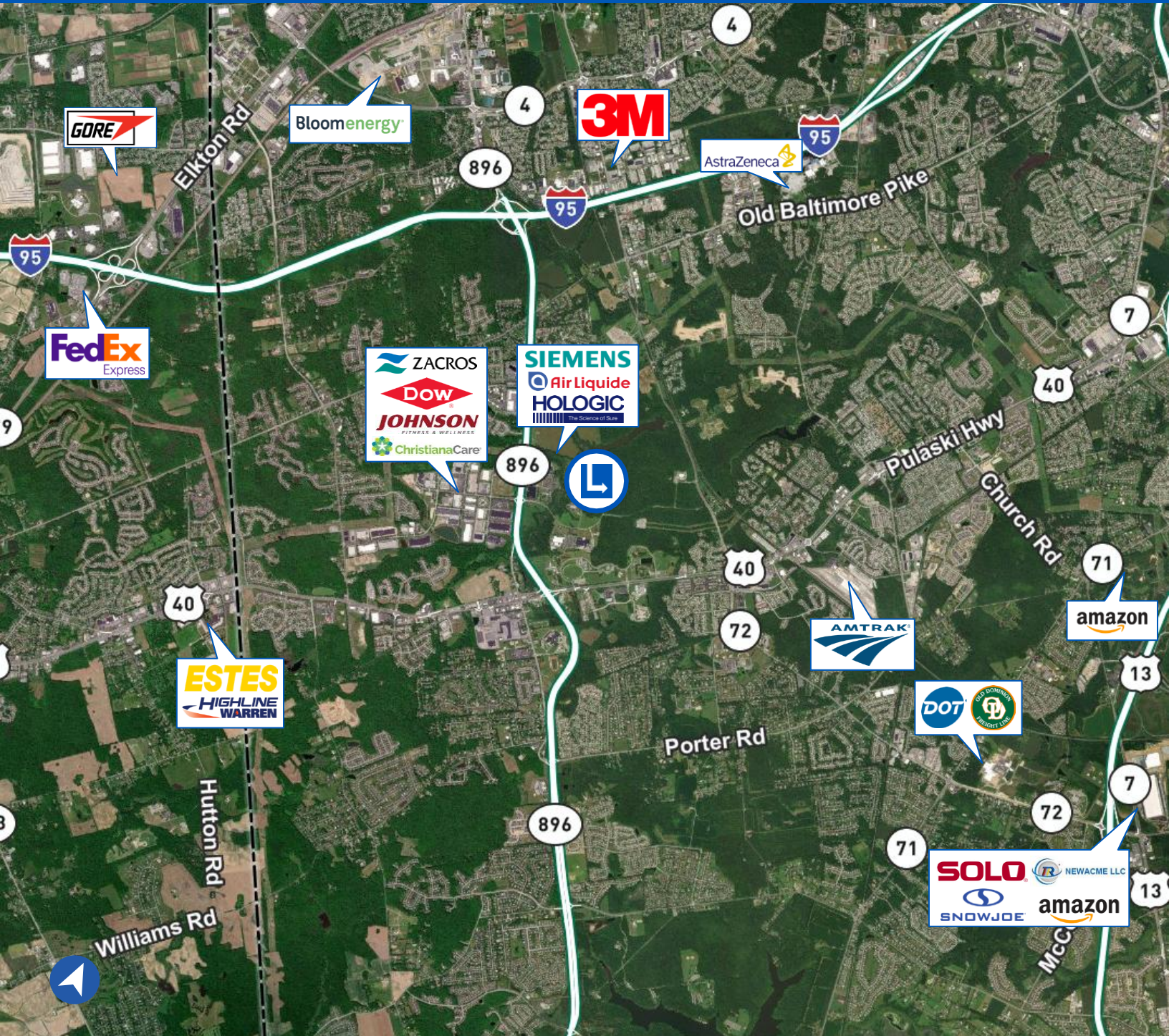



**LOGISTICS<sup>®</sup>**  
**PROPERTY**  
**CO**

# FIRST STATE LOGISTICS PARK

2051 Old Coches Bridge Road, Newark, Delaware 19702

[www.firststatelogisticspark.com](http://www.firststatelogisticspark.com)

