



**LOGISTICS<sup>®</sup>**  
PROPERTY  
CO

# SOUTHERN STAR LOGISTICS PARK

3210 Railport Parkway, Midlothian, TX 76065



## BUILDING/SITE INFORMATION



- 548,340 SF
- 2,623 Spec Office
- 185' Truck Courts
- 570' Building Depth
- Expandable up to 1msf
- 60' Speed Bays
- US-67 Access
- Established Park Setting
- 96 Dock Doors
- 132 Trailer Parking Spots (Expandable to 204)
- 228 Car Parking Spots
- ESFR Fire Suppression System
- 25 fc LED Warehouse Sensor Lighting on 15' Whips
- 8 Rite Hite 40K lb. Capacity Mechanical Pit Levelers (w/ Access to More on Order)

# CBRE

### CBRE

2100 McKinney Ave  
Suite 700  
Dallas, TX 75201

### Kacy Jones

+1 214 979 6151 • [kacy.jones@cbre.com](mailto:kacy.jones@cbre.com)

### Steve Koldyke

+1 214 979 6381 • [steve.koldyke@cbre.com](mailto:steve.koldyke@cbre.com)

### Brian Gilchrist

+1 214 979 6394 • [brian.gilchrist@cbre.com](mailto:brian.gilchrist@cbre.com)



**LOGISTICS<sup>®</sup>**  
PROPERTY  
CO

# SOUTHERN STAR LOGISTICS PARK

3210 Railport Parkway, Midlothian, TX 76065

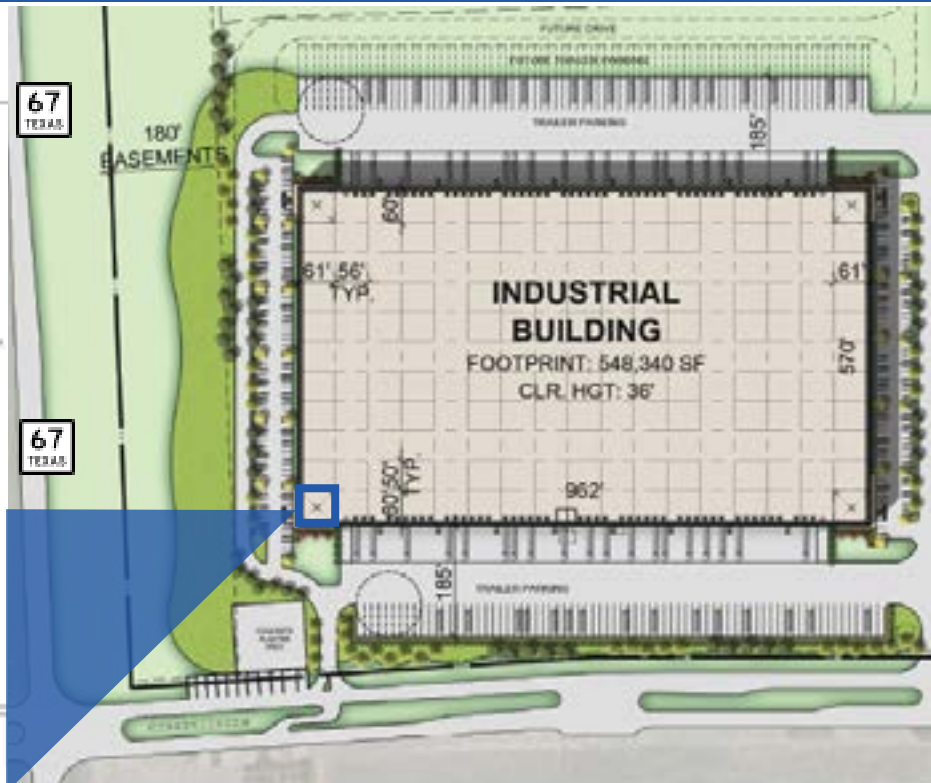
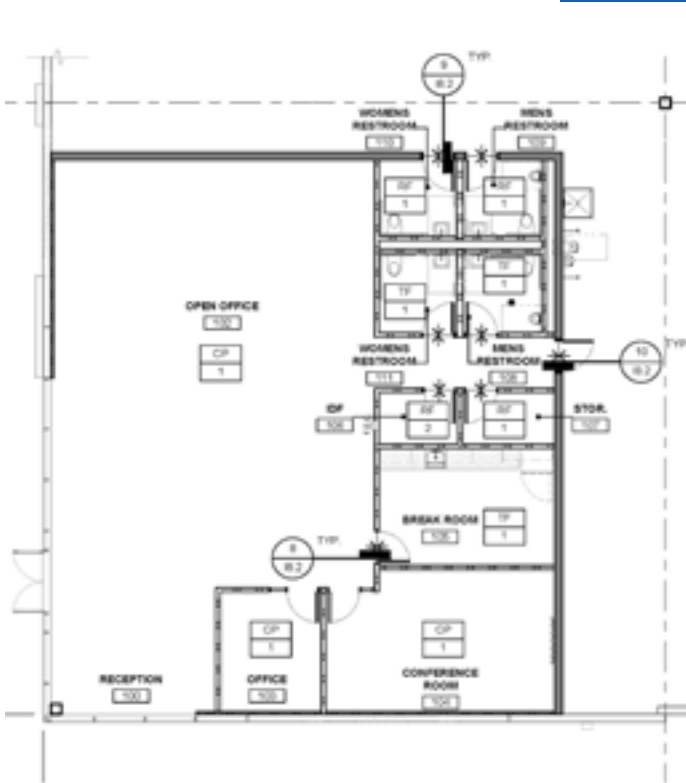

## HIGHLIGHTS

### Logistical Advantages

- US-67 Access
- Proximity to US-287
- Dual-Rail Service (BNSF and UP)

### Park Incentives

- Park Setting
- City of Midlothian Economic Incentives

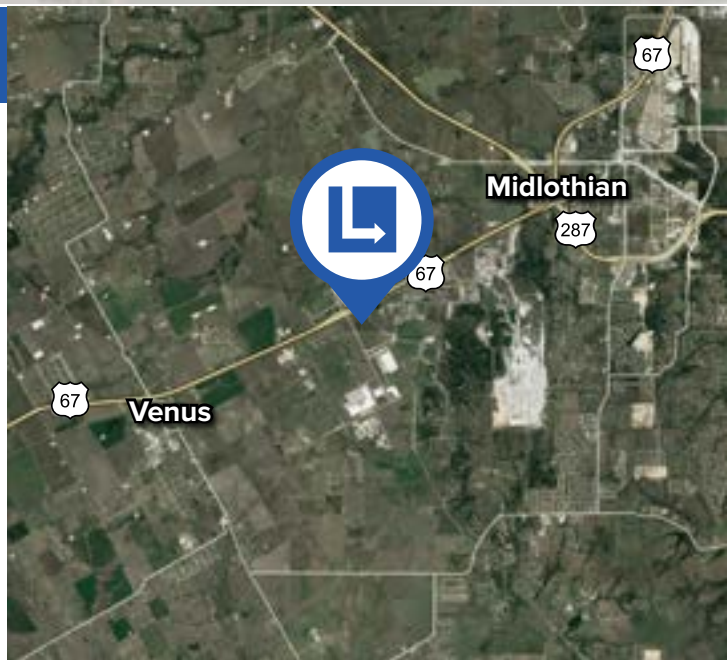

### CBRE

2100 McKinney Ave  
Suite 700  
Dallas, TX 75201

### Kacy Jones

+1 214 979 6151 • [kacy.jones@cbre.com](mailto:kacy.jones@cbre.com)

### Steve Koldyke

+1 214 979 6381 • [steve.koldyke@cbre.com](mailto:steve.koldyke@cbre.com)

### Brian Gilchrist

+1 214 979 6394 • [brian.gilchrist@cbre.com](mailto:brian.gilchrist@cbre.com)



**LOGISTICS<sup>®</sup>**  
PROPERTY  
CO

# SOUTHERN STAR LOGISTICS PARK

3210 Railport Parkway, Midlothian, TX 76065

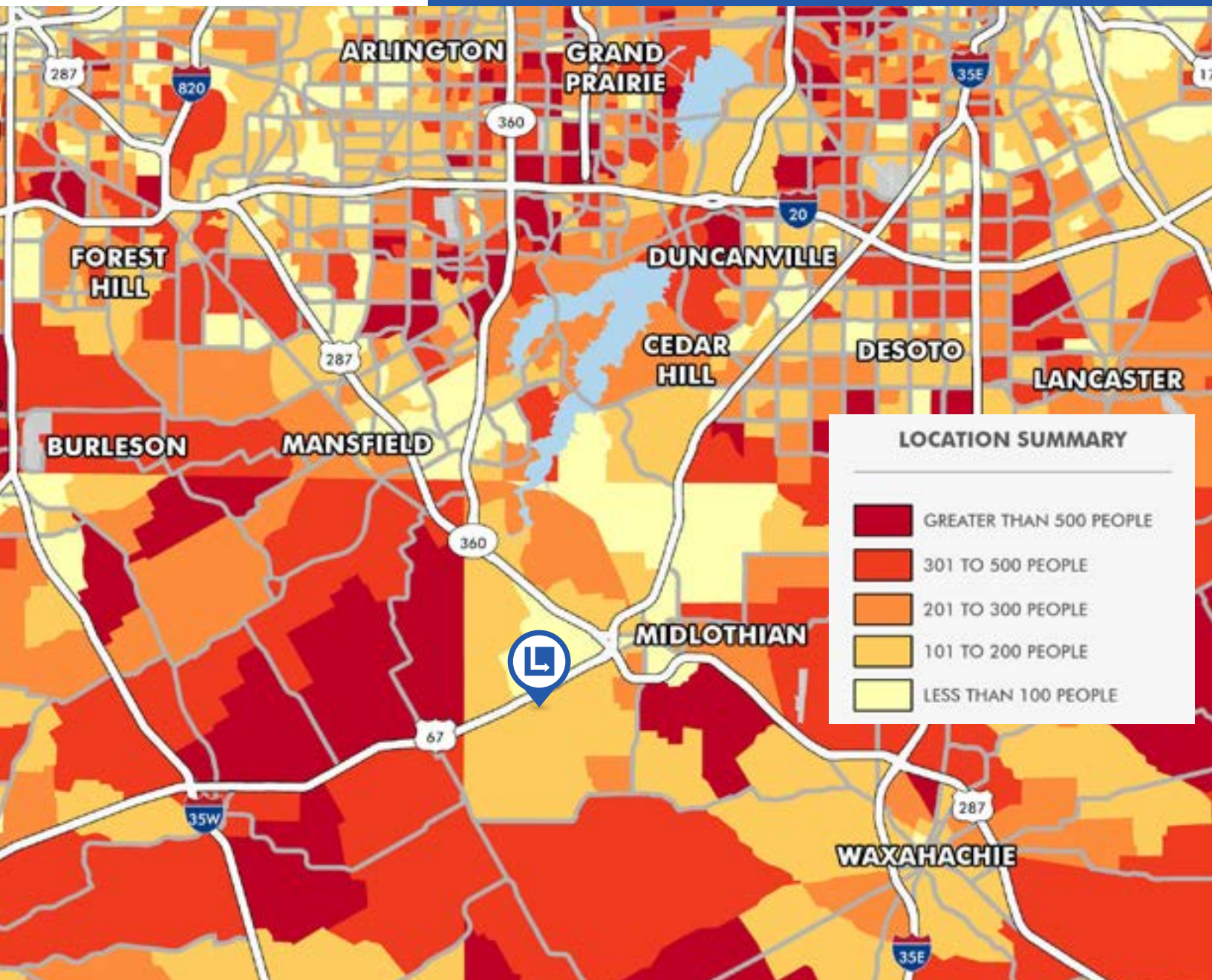

*Southern Star Logistics Park has immediate access to highly qualified blue collar labor*

© 2022 CBRE, Inc. All rights reserved. This information has been obtained from sources believed reliable but has not been verified for accuracy or completeness. You should conduct a careful, independent investigation of the property and verify all information. Any reliance on this information is solely at your own risk. CBRE and the CBRE logo are service marks of CBRE, Inc. All other marks displayed on this document are the property of their respective owners, and the use of such logos does not imply any affiliation with or endorsement of CBRE.

**CBRE**  
2100 McKinney Ave  
Suite 700  
Dallas, TX 75201

**Kacy Jones**  
+1 214 979 6151 • [kacy.jones@cbre.com](mailto:kacy.jones@cbre.com)

**Steve Koldyke**  
+1 214 979 6381 • [steve.koldyke@cbre.com](mailto:steve.koldyke@cbre.com)

**Brian Gilchrist**  
+1 214 979 6394 • [brian.gilchrist@cbre.com](mailto:brian.gilchrist@cbre.com)