



**LOGISTICS<sup>®</sup>**  
**PROPERTY**  
**CO**

# FREDERICKSON ONE, BLDG. 7

20015 34th Avenue E, Spanaway, WA 98387



**312,225 SF • COMPLETED 2023 - AVAILABLE NOW**

- 312,225 SF total (divisible) with 4,676 SF office
- 36' clear height
- 52 dock-high doors, 2 grade-level doors
- 34 trailer parking stalls, 158 auto parking stalls
- ESFR sprinklers
- 56' x 50' column spacing
- Designed & constructed to LEED standards
- Solar-ready; dedicated capacity for on-site solar system (suitable for ~500 kW system)
- LED lighting
- Reflective roof membrane to reduce heat absorption
- Drought-tolerant plants
- Low flow plumbing fixtures
- Energy efficient building design measures and mechanical systems, including R30 envelope
- Low VOC interior finishes



**Colliers**

601 Union St, Suite 5300  
 Seattle, WA 98101

**Matt McGregor**

+1 206 624 7401 • matt.mcgregor@colliers.com

**Bill Condon**

+1 206 235 9732 • bill.condon@colliers.com





**LOGISTICS<sup>®</sup>**  
 PROPERTY  
 CO

# FREDERICKSON ONE, BLDG. 7

20015 34th Avenue E, Spanaway, WA 98387

## Site Plan

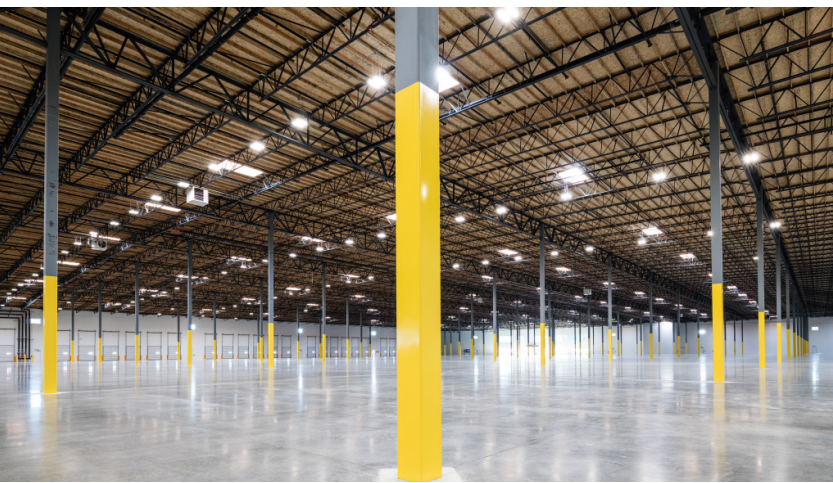
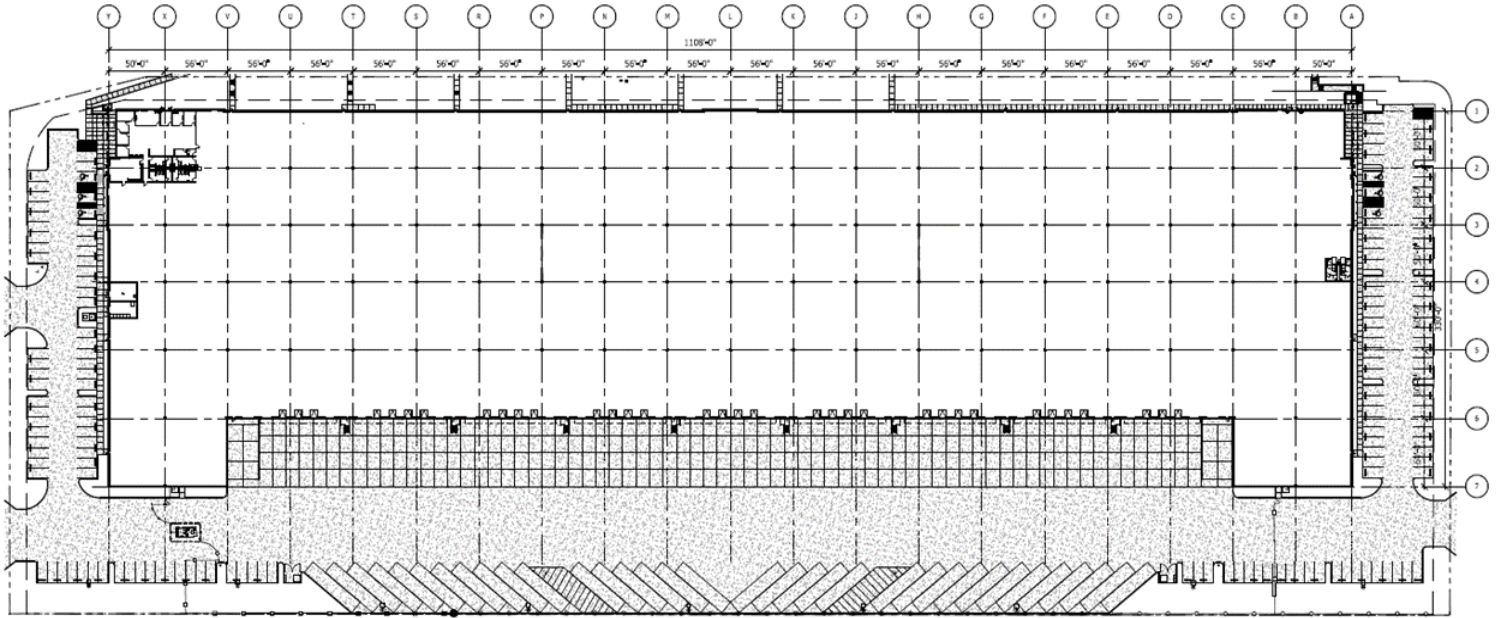

**Colliers**  
 601 Union St, Suite 5300  
 Seattle, WA 98101

**Matt McGregor**  
 +1 206 624 7401 • [matt.mcgregor@colliers.com](mailto:matt.mcgregor@colliers.com)

**Bill Condon**  
 +1 206 235 9732 • [bill.condon@colliers.com](mailto:bill.condon@colliers.com)



**Office Plan**

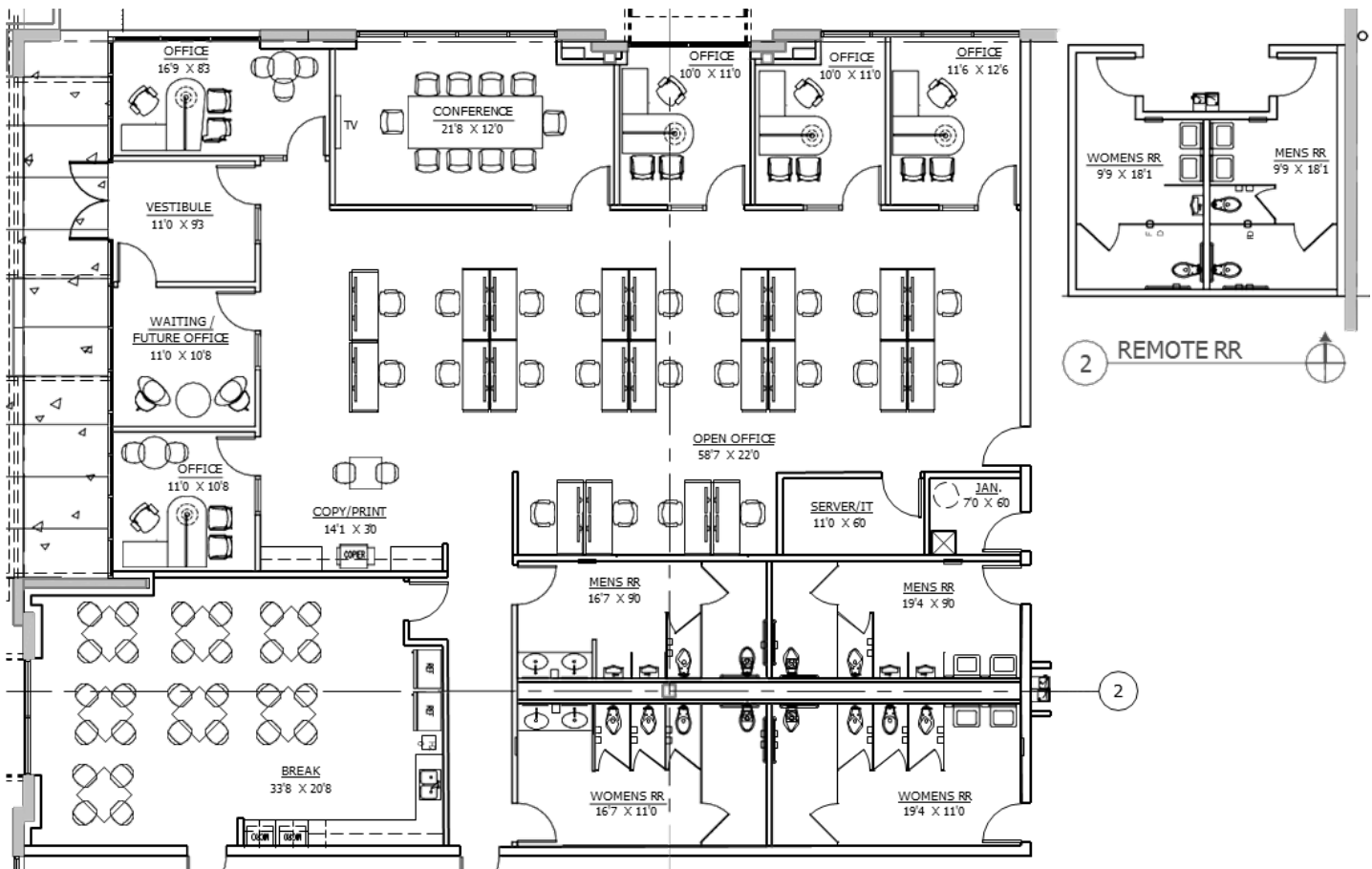

**Colliers**  
 601 Union St, Suite 5300  
 Seattle, WA 98101

**Matt McGregor**  
 +1 206 624 7401 • matt.mcgregor@colliers.com

**Bill Condon**  
 +1 206 235 9732 • bill.condon@colliers.com