



**LOGISTICS<sup>®</sup>**  
PROPERTY  
CO

# CITYPARK LOGISTICS CENTER

Northwest corner of Beltway 8 and Highway 90, Missouri City, TX 77489



## HIGHLIGHTS: BUILDING 3 - 199,170 SF

- Divisible
- 52' x 58'-9" bays
- 60' speed bays
- Cross docked
- ESFR sprinklers
- 32' clear height
- 185' single user truck court and 230' shared
- Capacity for 32 trailer parking spaces
- Truck and trailer storage
- Capacity for 198 parking spaces
- 48 - 9' x 10' overhead doors
- 4 - 14' x 16' overhead doors
- **Lease Rate - Contact Broker**

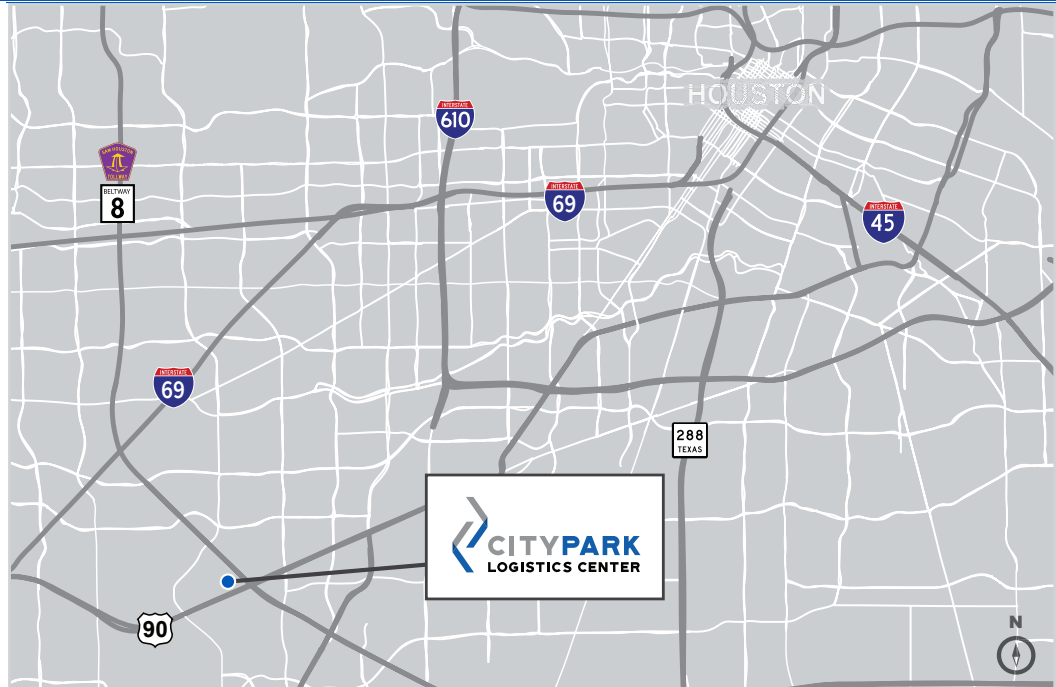

**CUSHMAN &  
WAKEFIELD**

**Cushman & Wakefield**

1330 Post Oak Boulevard,  
Suite 2700  
Houston, TX 77056

**Beau Kaleel**

+1 713 963 2844 • [beau.kaleel@cushwake.com](mailto:beau.kaleel@cushwake.com)

**Brooke Forrest**

+1 713 331 1735 • [brooke.forrest1@cushwake.com](mailto:brooke.forrest1@cushwake.com)



**LOGISTICS<sup>®</sup>**  
PROPERTY  
CO

# CITYPARK LOGISTICS CENTER

Northwest corner of Beltway 8 and Highway 90, Missouri City, TX 77489

## SITE

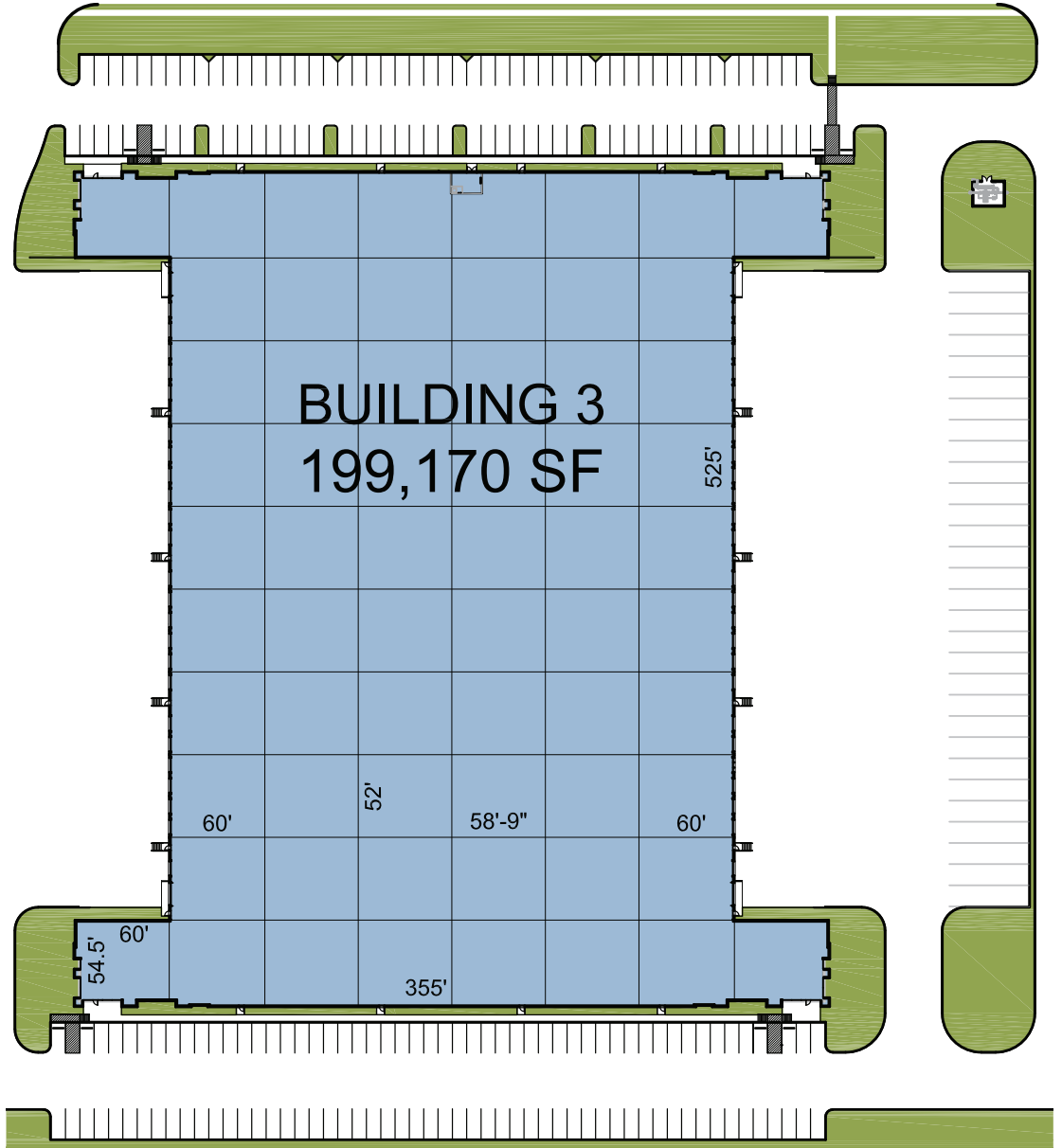
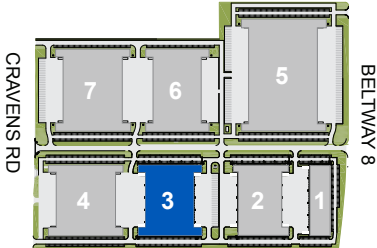

**CUSHMAN &  
WAKEFIELD**

**Cushman & Wakefield**  
1330 Post Oak Boulevard,  
Suite 2700  
Houston, TX 77056

**Beau Kaleel**  
+1 713 963 2844 • [beau.kaleel@cushwake.com](mailto:beau.kaleel@cushwake.com)

**Brooke Forrest**  
+1 713 331 1735 • [brooke.forrest1@cushwake.com](mailto:brooke.forrest1@cushwake.com)