

LOGISTICS[®]
PROPERTY
CO

CITYPARK LOGISTICS CENTER

Northwest corner of Beltway 8 and Highway 90, Missouri City, TX 77489



HIGHLIGHTS: BUILDING 3 - 199,170 SF

- 52' x 58'-9" bays
- 60' speed bays
- Cross docked
- ESFR sprinklers
- 32' clear height
- 185' single user truck court and 230' shared
- Capacity for 32 trailer parking spaces
- Truck and trailer storage
- Capacity for 198 parking spaces
- 48 - 9' x 10' overhead doors
- 4 - 14' x 16' overhead doors
- **Lease Rate - Contact Broker**

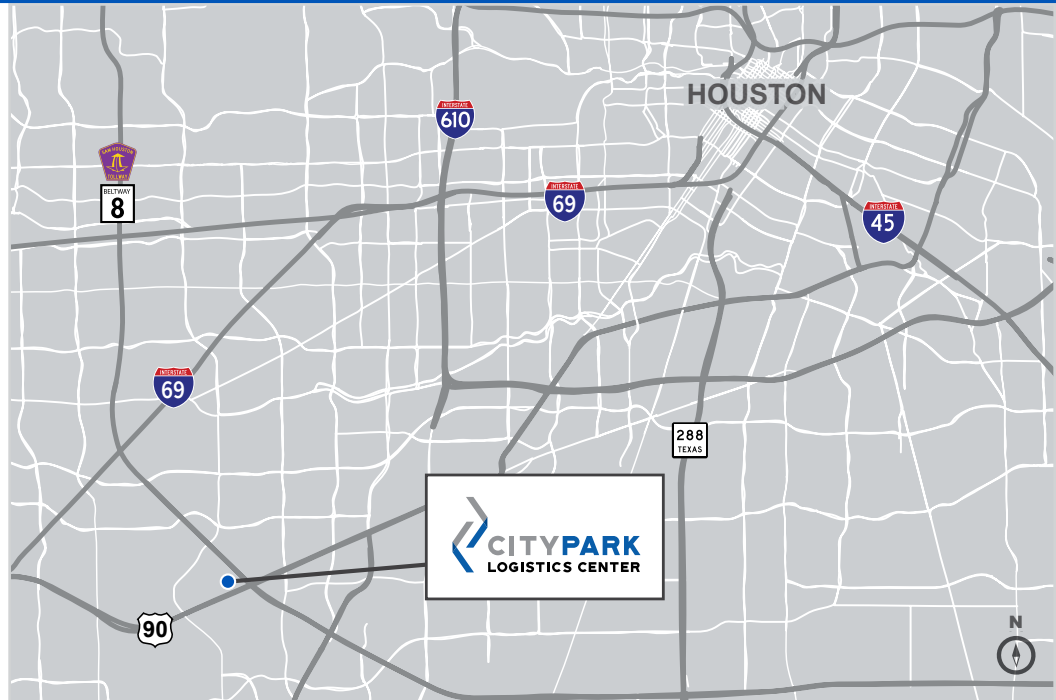

JLL
1400 Post Oak Boulevard,
Suite 1100
Houston, TX 77056

John M. Talhelm
+1 713 888 4058 • john.talhelm@am.jll.com

Kevin Erck, SIOR
+1 713 888 4067 • kevin.erck@am.jll.com



LOGISTICS[®]
PROPERTY
CO

CITYPARK LOGISTICS CENTER

Northwest corner of Beltway 8 and Highway 90, Missouri City, TX 77489

SITE

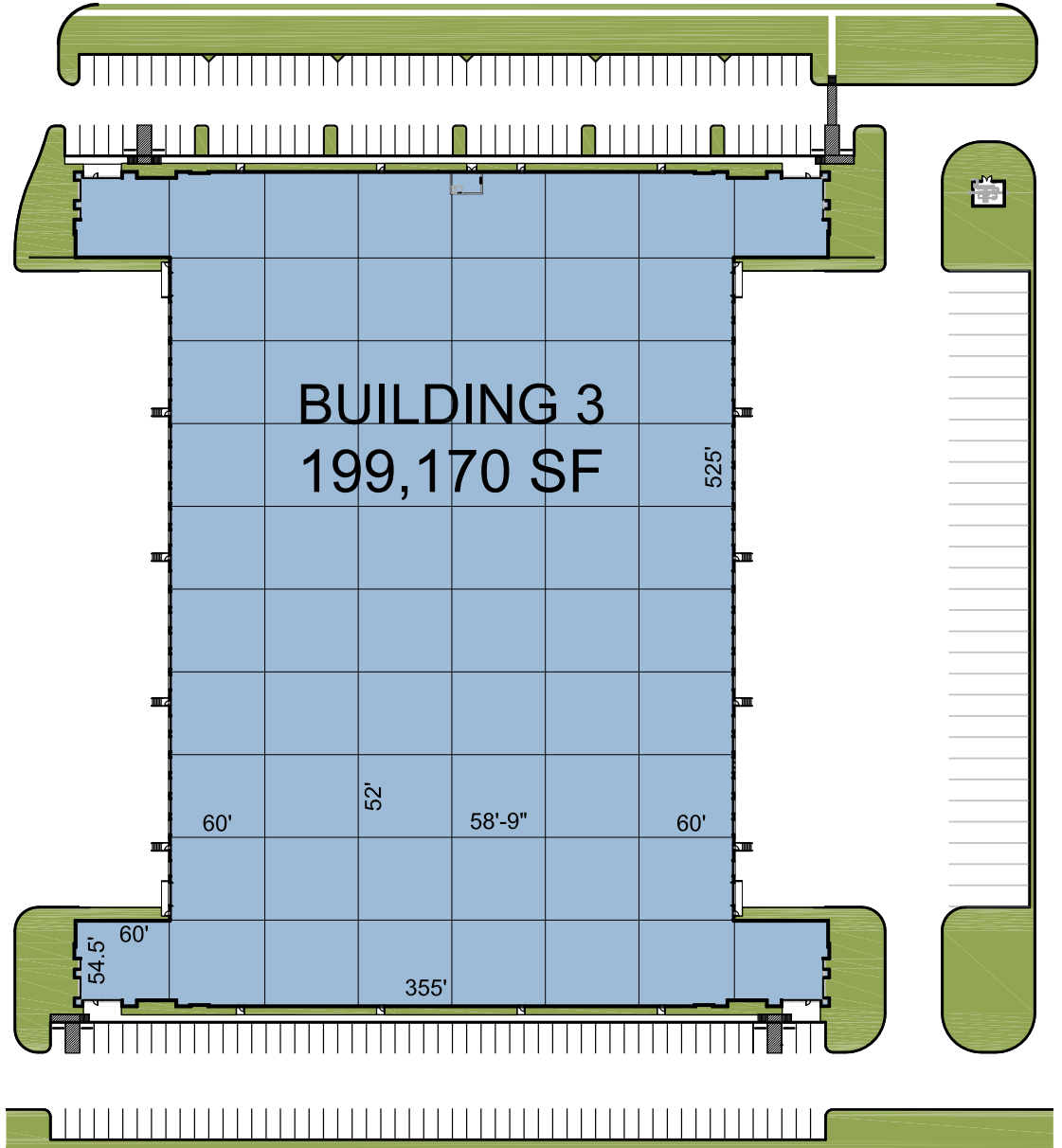
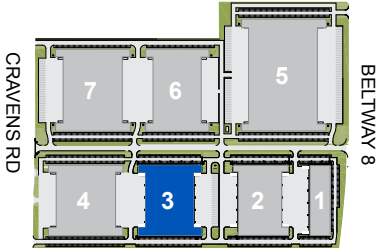

JLL
1400 Post Oak Boulevard,
Suite 1100
Houston, TX 77056

John M. Talhelm
+1 713 888 4058 • john.talhelm@am.jll.com

Kevin Erck, SIOR
+1 713 888 4067 • kevin.erck@am.jll.com