



**LOGISTICS<sup>®</sup>**  
PROPERTY  
CO

# SWIFT & LAKE

Southeast corner of Swift Road & Lake Street, Addison, IL 60101



## TWO BUILDINGS TOTALING 278,250 SF • DELIVERING SUMMER 2020

- State-of-the art, Class A distribution facilities
- Divisible to suit small and mid-size users
- Offering a total of 56 exterior loading docks
- 0.25 mile to I-355 four-way interchange
- 1.5 miles to I-290
- 8 miles to I-294
- 7 miles to O'Hare International Airport
- 25 miles to Downtown Chicago
- Highly desirable DuPage County location
- Flexible 15.09-acre property
- Remarkable access to skilled labor and end users

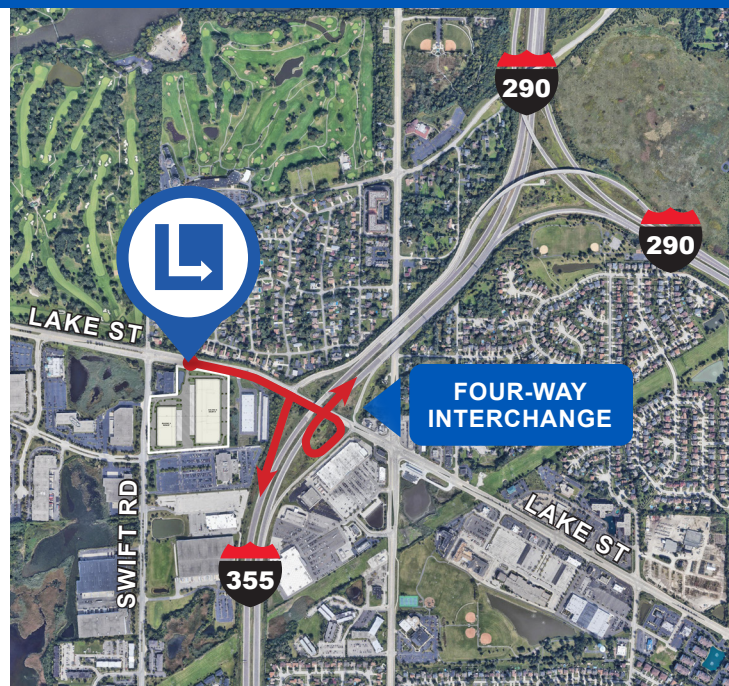

**CUSHMAN &  
WAKEFIELD**

**Cushman & Wakefield**

9500 West Bryn Mawr  
Avenue, Suite 600  
Rosemont, IL 60018

**Doug Pilcher**

+1 847 518 3285 • [doug.pilcher@cushwake.com](mailto:doug.pilcher@cushwake.com)

**Jason West, SIOR**

+1 847 518 3210 • [jason.west@cushwake.com](mailto:jason.west@cushwake.com)

**Sean Henrick, SIOR, CCIM**

+1 847 518 3215 • [sean.henrick@cushwake.com](mailto:sean.henrick@cushwake.com)





**LOGISTICS<sup>®</sup>**  
**PROPERTY**  
**CO**

# SWIFT & LAKE

Southeast corner of Swift Road & Lake Street, Addison, IL 60101

**15.09-ACRE PROPERTY**

**278,250 SF DELIVERING SUMMER 2020**

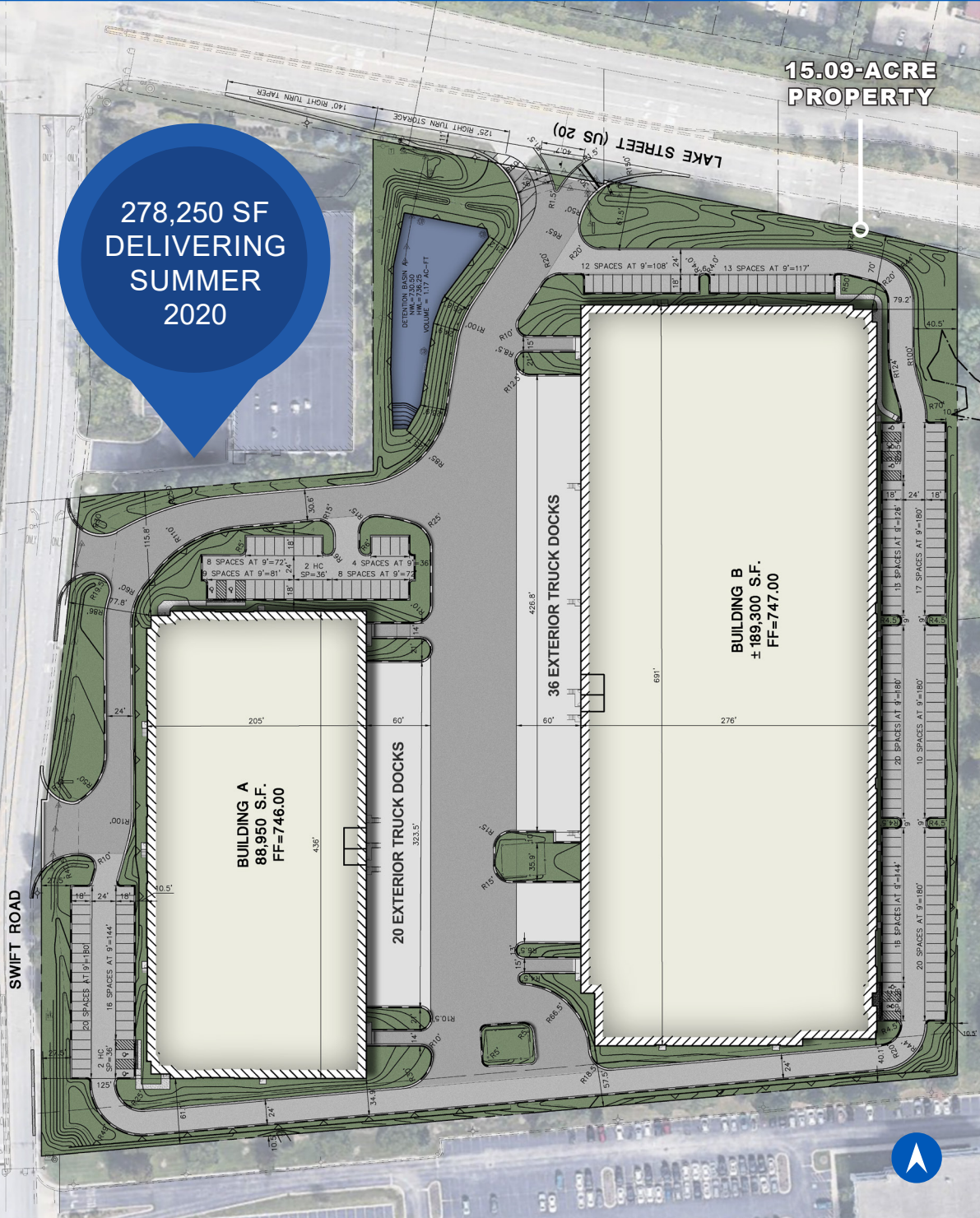

**32' CLEAR HEIGHTS**



**DIVISIBLE FLOOR PLANS**



**OFFICES TO SUIT**



**AMPLE PARKING**



**CUSHMAN & WAKEFIELD**

**Cushman & Wakefield**

9500 West Bryn Mawr Avenue, Suite 600  
Rosemont, IL 60018

**Doug Pilcher**

+1 847 518 3285 • doug.pilcher@cushwake.com

**Jason West, SIOR**

+1 847 518 3210 • jason.west@cushwake.com

**Sean Henrick, SIOR, CCIM**

+1 847 518 3215 • sean.henrick@cushwake.com





**LOGISTICS<sup>®</sup>**  
PROPERTY  
CO

# SWIFT & LAKE

Southeast corner of Swift Road & Lake Street, Addison, IL 60101

PRIME LOCATION FOR  
LAST-MILE, NATIONAL &  
GLOBAL DISTRIBUTION

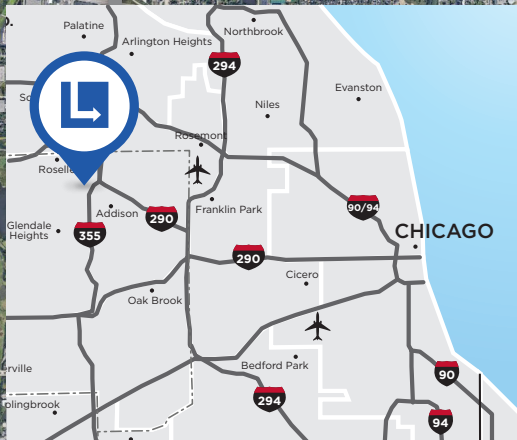
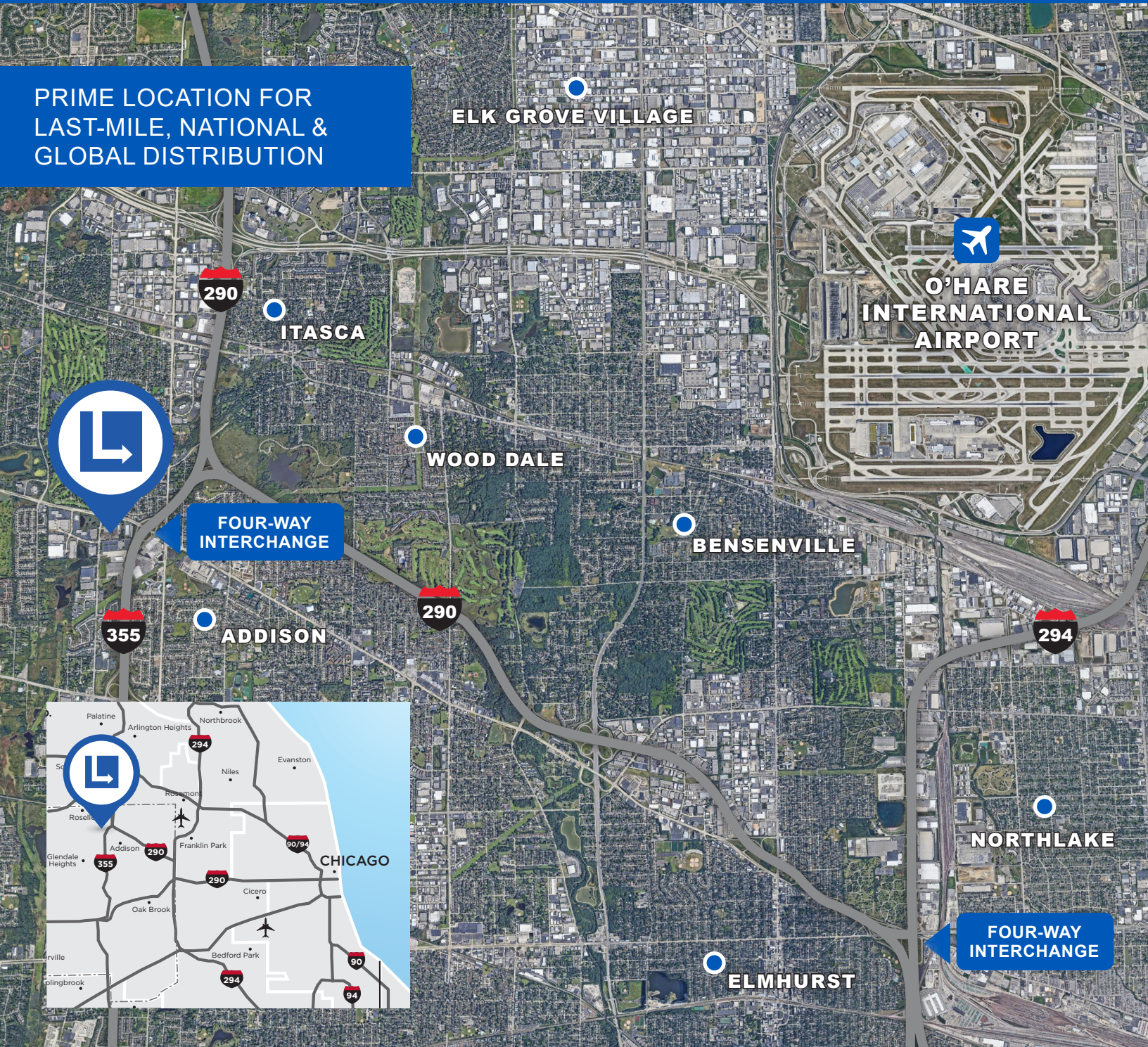

**CUSHMAN &  
WAKEFIELD**

**Cushman & Wakefield**

9500 West Bryn Mawr  
Avenue, Suite 600  
Rosemont, IL 60018

**Doug Pilcher**

+1 847 518 3285 • [doug.pilcher@cushwake.com](mailto:doug.pilcher@cushwake.com)

**Jason West, SIOR**

+1 847 518 3210 • [jason.west@cushwake.com](mailto:jason.west@cushwake.com)

**Sean Henrick, SIOR, CCIM**

+1 847 518 3215 • [sean.henrick@cushwake.com](mailto:sean.henrick@cushwake.com)